

CIP # 16-011 - Oneida Recreation Complex

Project Description:

The project would provide a centrally located community recreation complex which supports the social, cultural, physical, and recreational needs of the Oneida Community. The project that will address a holistic approach to providing community recreational and social programming. The facility will consist of: gymnasium, youth learning and activity components, arts and craft space, cafeteria, events areas, small locker room, storage spaces and various administrative spaces.

The project is being coordinated with CDC #13-011 Oneida Nation High School with the intention that they will share a site/campus. This campus approach will allow both developments to share access to certain functions and exterior amenities such as playgrounds, ball fields, parking, etc.

The project will consist of an estimated 43,715 square foot building and designed to accommodate future expansions to meet the full desired space program. The site analysis for the campus determined a need for 50 to 60 acres of property.

Architect of Record: Somerville, Inc.
Construction Management: Miron Construction, Inc.
Commissioning Services: Farnsworth Group, Inc.

Current Status:

- Site Master Planning concept approved. Refer to Page 2.
- Wetland Impact evaluations in progress.
- Continued discussions with WisDOT.
- Schematic Design process underway. Refer to Page 2.
- Food Service review.

Schedule:

Approvals - Complete
Design - In Progress
Bidding - February 2027 (Estimated)
Construction - Start Spring 2027 (Estimated)
Substantial Completion - TBD



ONEIDA
RECREATION



CIP # 16-011 - Oneida Recreation Complex

Site Master Plan Concept:

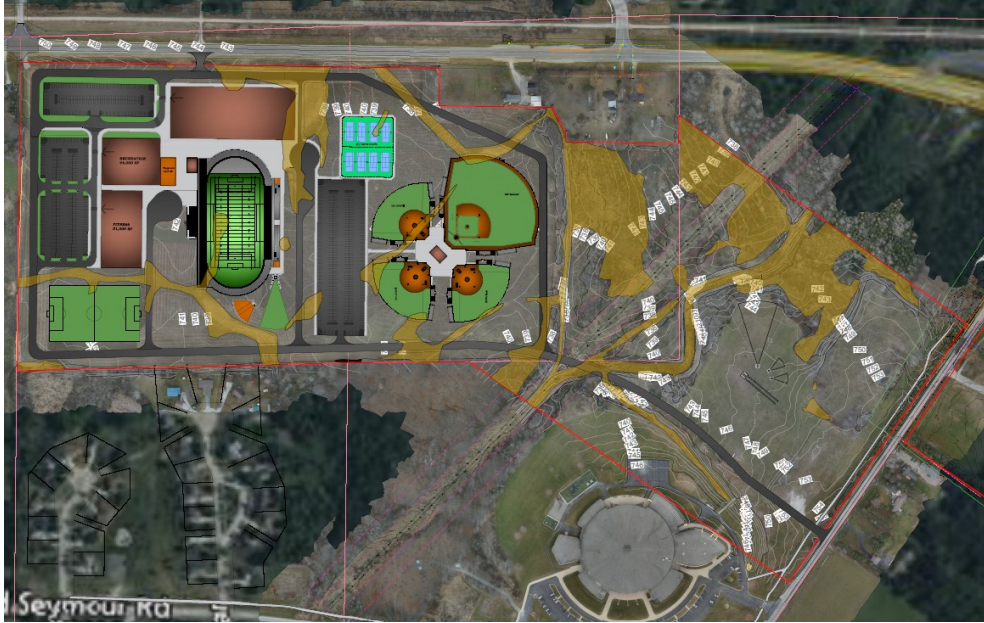

Current Schematic Design:

